

## Dimension Drawing

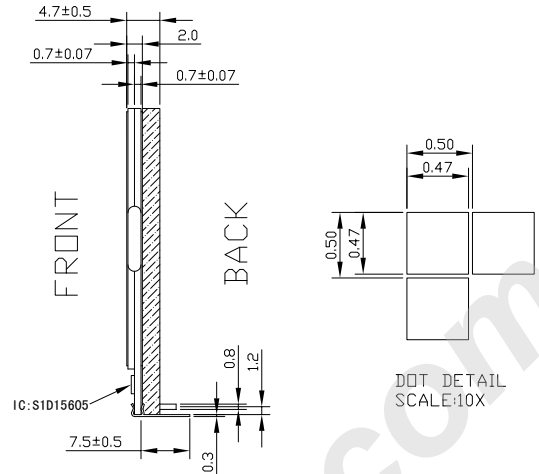
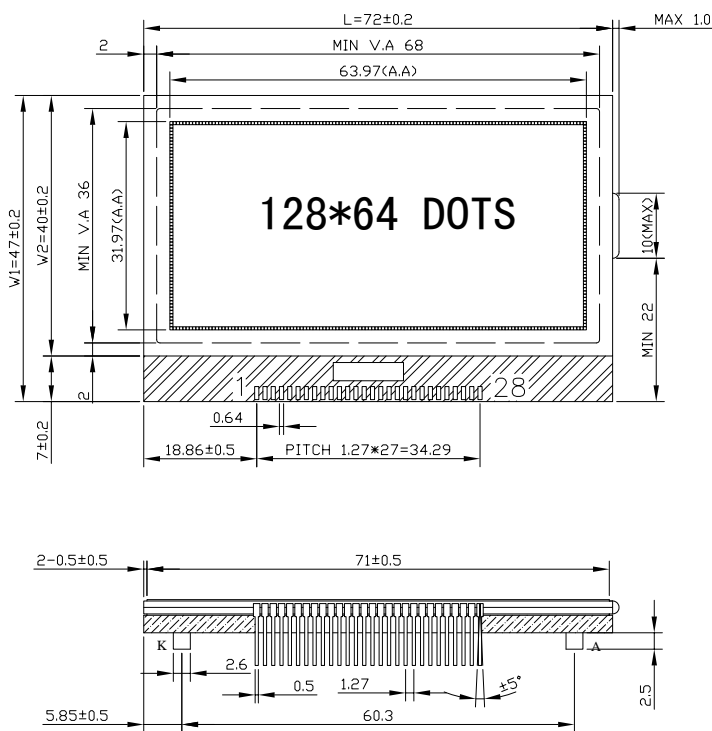

TOLERANCES UNLESS OTHERWISE STATED  
 X.X 0.20 X.XX 0.10 UNIT: mm

### Feature:

1. 128 x 64 dots graphic display
2. Built-in controller S1D15605
3. +3.3V Or +5.0V power supply
4. 1/64 Duty cycle
5. STN or FSTN Mode
6. Match all kind colors of LED back light
7. ROHS compliant

### Mechanical Data

Item	Standard	Unit
Module dimension	72.0 x 47.0	mm
Viewing area	68.0 x 36.0	mm
Dots pitch	0.47 x 0.47	mm
Dots size	0.50 x 0.50	mm

### Interface Pin Connections

PIN NO.	Symbol	PIN NO.	Symbol
1	C86	15	VDD
2	VSS	16	DB7
3	V5	17	DB6
4	V4	18	DB5
5	V3	19	DB4
6	V2	20	DB3
7	V1	21	DB2
8	CAP2P	22	DB1
9	CAP2N	23	DB0
10	CAP1N	24	RD(E)
11	CAP1P	25	WR(R/W)
12	CAP3N	26	A0
13	VOUT	27	RESETB
14	VSS	28	CS1

### Absolute Maximum Rating

Item	Symbol	Standard			Unit
		Min	Typ	Max	
Power supply	VDD-VSS	-0.3	---	7.0	V
Input voltage	Vin	-18	---	0.3	

### Electronical Characteristics

Item	Symbol	Condition	Standard			Unit
			Min	Typ	Max	
Input voltage	VDD	+3.0V	1.8	3.3	5.5	V
Supply current	I <sub>DD</sub>	VDD=3V	---	18	27	uA
Recommended LCD driving voltage for normal temp version module	V5-VDD (VDD=3V)	-20°C	9.8	---	---	V
		0°C	9.6	9.8	---	
		25°C	9.4	9.6	9.8	
		50°C	---	9.4	9.6	
		70°C	---	---	9.4	
LED forward voltage	V <sub>F</sub>	25°C	---	3.1	3.3	V
LED forward current	I <sub>F</sub>	25°C Edge	---	90	120	mA