

Dimension Drawing

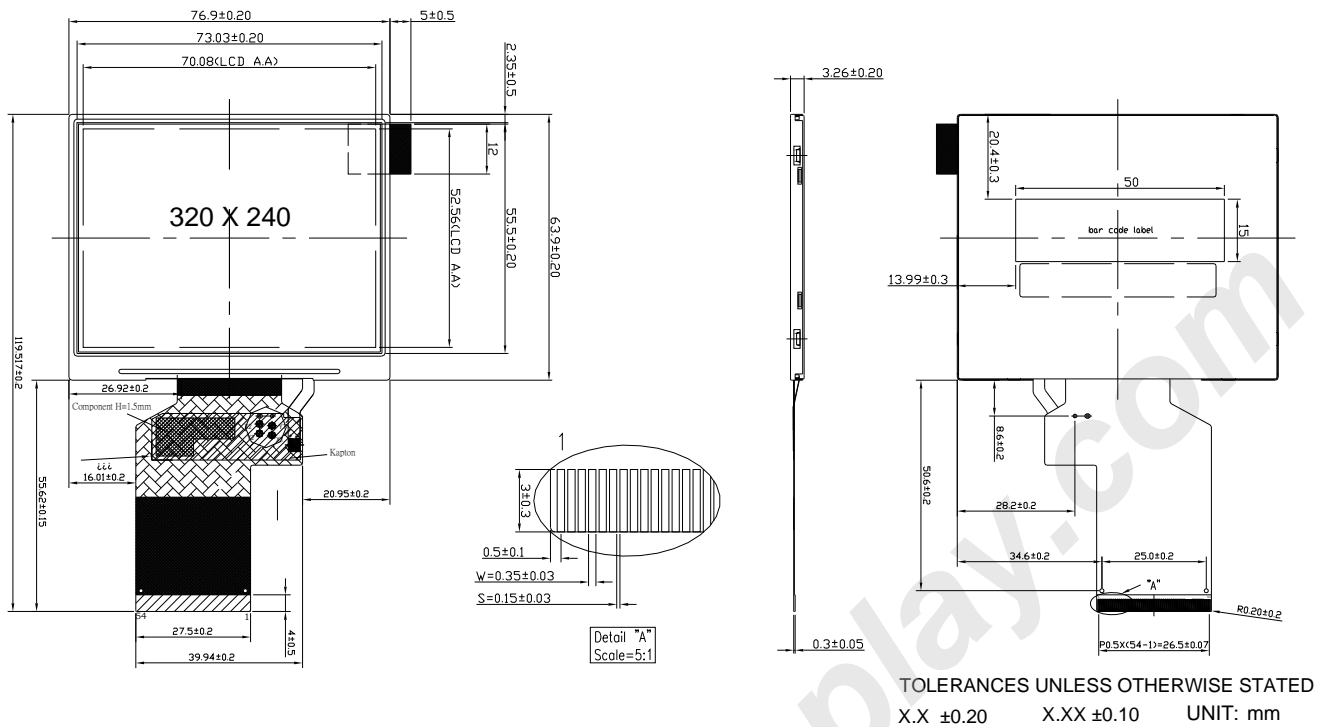

Feature:

1. Resolution is 320 (RGB) x 240 Pixel
2. +3.3V power supply
3. Display Mode is TN, Normal White
4. Display color is 65K/262K colors
5. Input Interface is 8 bits 8080/6800 MCU system interface
6. It could be matched resistive or capacitance touch panel
7. ROHS compliant

Interface Pin Connections

PIN NO.	Symbol	PIN NO.	Symbol
1	VBL-	28	R0
2	VBL-	29	R1
3	VBL+	30	R2
4	VBL+	31	R3
5	Y1	32	R4
6	X1	33	R5
7	NC	34	R6
8	/RESET	35	R7
9	SPENA	36	HSYNC
10	SPCLK	37	VSYNC
11	SPDAT	38	DCLK
12	B0	39	NC
13	B1	40	NC
14	B2	41	VCC
15	B3	42	VCC
16	B4	43	Y2
17	B5	44	X2
18	B6	45	NC
19	B7	46	NC
20	G0	47	NC
21	G1	48	IF2
22	G2	49	IF1
23	G3	50	IF0
24	G4	51	NC
25	G5	52	DE
26	G6	53	GND
27	G7	54	GND

Mechanical Data

Item	Standard	Unit
Module dimension	76.9 x 63.9 x 3.3	mm
Active area	70.08 x 52.56	mm
Dots pitch	0.219 x 0.219	mm
Screen size	3.5 (Diagonal)	inches

Absolute Maximum Rating

Item	Symbol	Standard			Unit
		Min	Typ	Max	
Power supply	DVDD	-0.3	---	5.0	V
Logic input voltage	Vci	-0.3	---	VDD+0.3	

Electronical Characteristics

Item	Symbol	Condition	Standard			Unit
			Min	Typ	Max	
Input voltage	VDDIO	+3.0V	3.0	3.3	3.6	V
Viewing angle	θL	9 o'clock	50	60	----	degree
	θR	3 o'clock	50	60	----	degree
	θU	12 o'clock	40	50	----	degree
	θD	6 o'clock	45	55	----	degree
Contrast ratio	CR	Best viewing angle	320	400	----	----
White luminance	ΔL	θ=Φ=0°	220	250	----	cd/m ²
LED forward voltage	VF	25°C	----	19.8	21.0	V
LED forward current	IF	25°C Edge	----	20	22	mA
Storage temp.	TOP	----	-20	----	80	°C
Operation temp.	TST	----	-30	----	90	°C